



Corporate Design

CFM Office

Location Vancouver, BC

Client CFM

Softwares Autocad

SketchUp

EnScape

CFM Office is a renovation project on office design that focus on to bring the specific theme idea to the chosen office. It focus on bring the strong image of the office to the customers and using the design idea to provide the unique working atmosphere to the staff who working here

About CFM



CFM have over 100 years of collective experience representing clients in large complex litigation files often with multi-jurisdictional features. It is a Vancouver civil litigation boutique known nationally and internationally for expertise in litigation pertaining to the fields of : aviation accident litigation, class action lawsuits, and product liability matters. Their lawyers have practice experience that includes counsel work in landmark and precedent setting cases in each of our practice areas. They frequently work with other lawyers and law firms who require experienced Canadian litigation counsel to represent their clients.



- Working Atitude:

 - Focus on the client
 - Taken small amount of files at a time
 - Every file is a priority file
- Partner:

 - Aviation Engineers
 - Econimic Experts
 - Mechanical and Forensic Engineers
 - Medical and Rehabilitation Experts
 - Metallurgists
 - Pilots
 - Weather Experts
- Working Place:

 - Through Canada
 - Partner with outside Canada

Inspiration Board & Concept

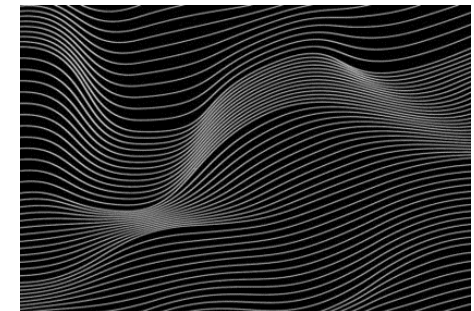
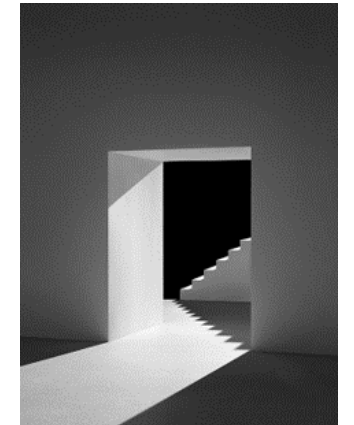
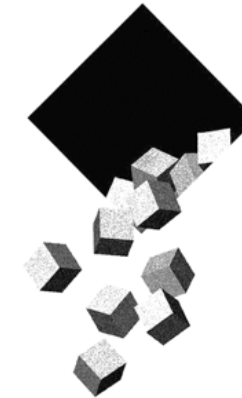
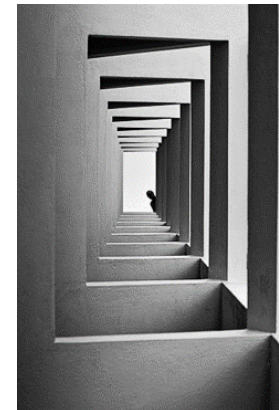

As a law firm, I think the main words of their company are serious, comprehensive, rigorous, and professional. So that my concept is "rigorous, meticulous" Black, white, and gray will be my main colors and modern furniture will be my choices. Because the company has a large number of people, and each lawyer needs an independent office to talk to clients, and the company needs a place to meet, the space planning must be rigorous. Color choosing is basic the simple black and white to represent the serious feelings and the gold color will be the decorations to enhanced a little bit relaxing feeling for the staff.

Floor Plan

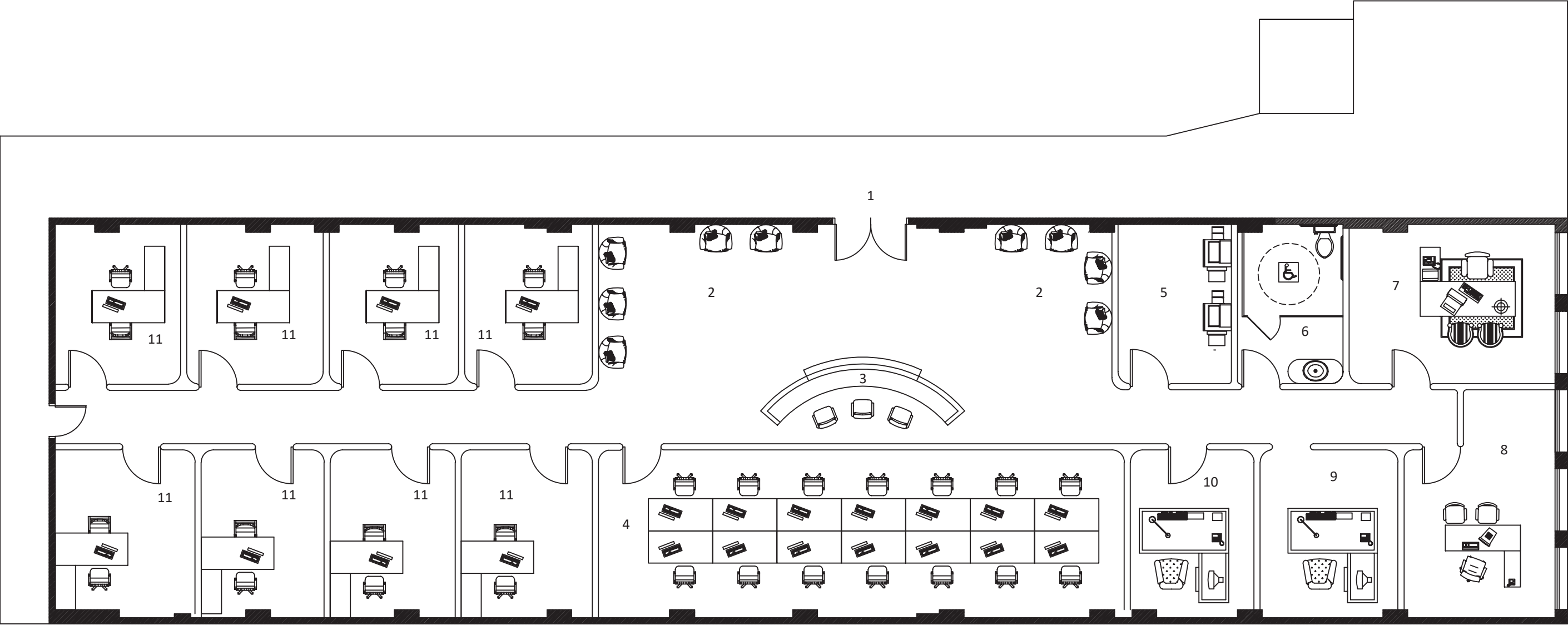

- LEGEND**
- 1. Entrance
 - 2. Waiting Area
 - 3. Reception
 - 4. Working Area
 - 5. Print Room
 - 6. Washroom
 - 7. Principle Office
 - 8. Manager Office
 - 9. Principle Office 2
 - 10. Principle Office 3
 - 11. Private Lawyer Office

General Bird View

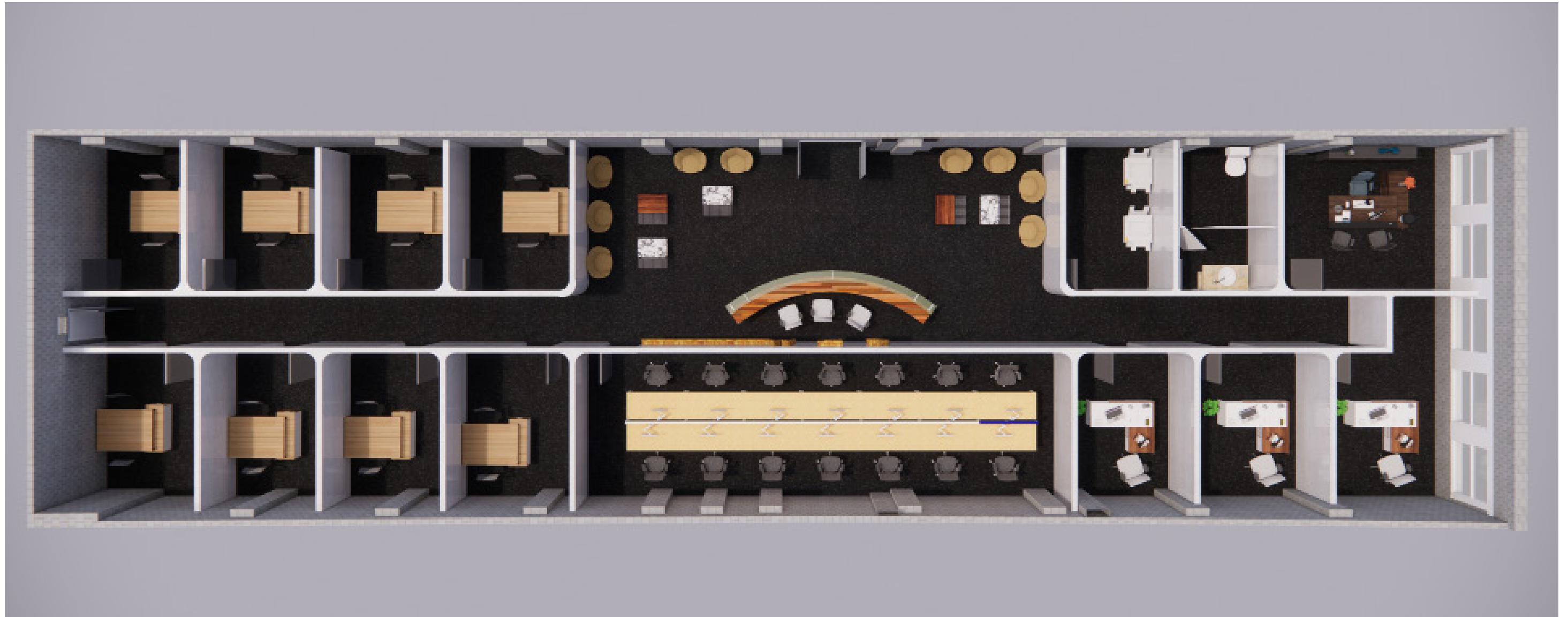

Based on the concept, the centre will be the large reception and separated waiting area for customers who either want to meet with the lawyers or the managers of the company, the large working area is provided at the back of reception which also will be using as the meeting room if is needed. The left side is the lawyers' private office and the right side is the managers' and CEO's office, large scale of dark carpet using through the company and light wall is provided, those two become the basic idea for the customers.

Renderings



The reception is using a wood texture table with the symbol of the company is the back to decorate the space, waiting area is using the same idea on the furniture in order to make the customer have better feeling.



Office using the stone texture back wall to enhance the feeling of clam, several window provided to relaxing the staff

