

WEDDING

DRESS

STORE

INTERIOR DESIGN
PORTFOLIO 2021
BOHAN YIN



CONTENT



SKETCHES

01

02

INTRODUCTION

BUBBLE DOAGRAM

03

04

FLOORPLAN

RENDERS

05

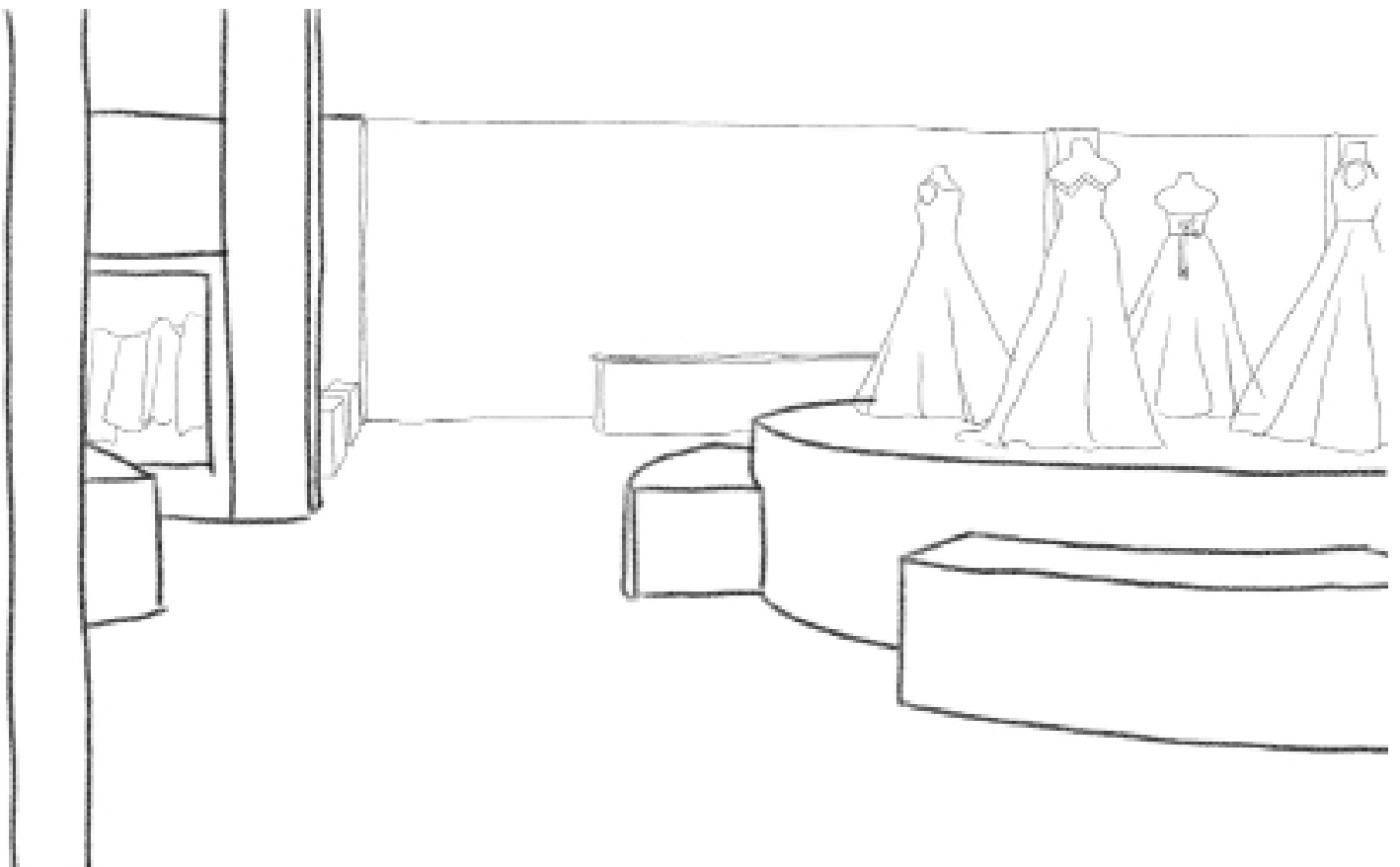
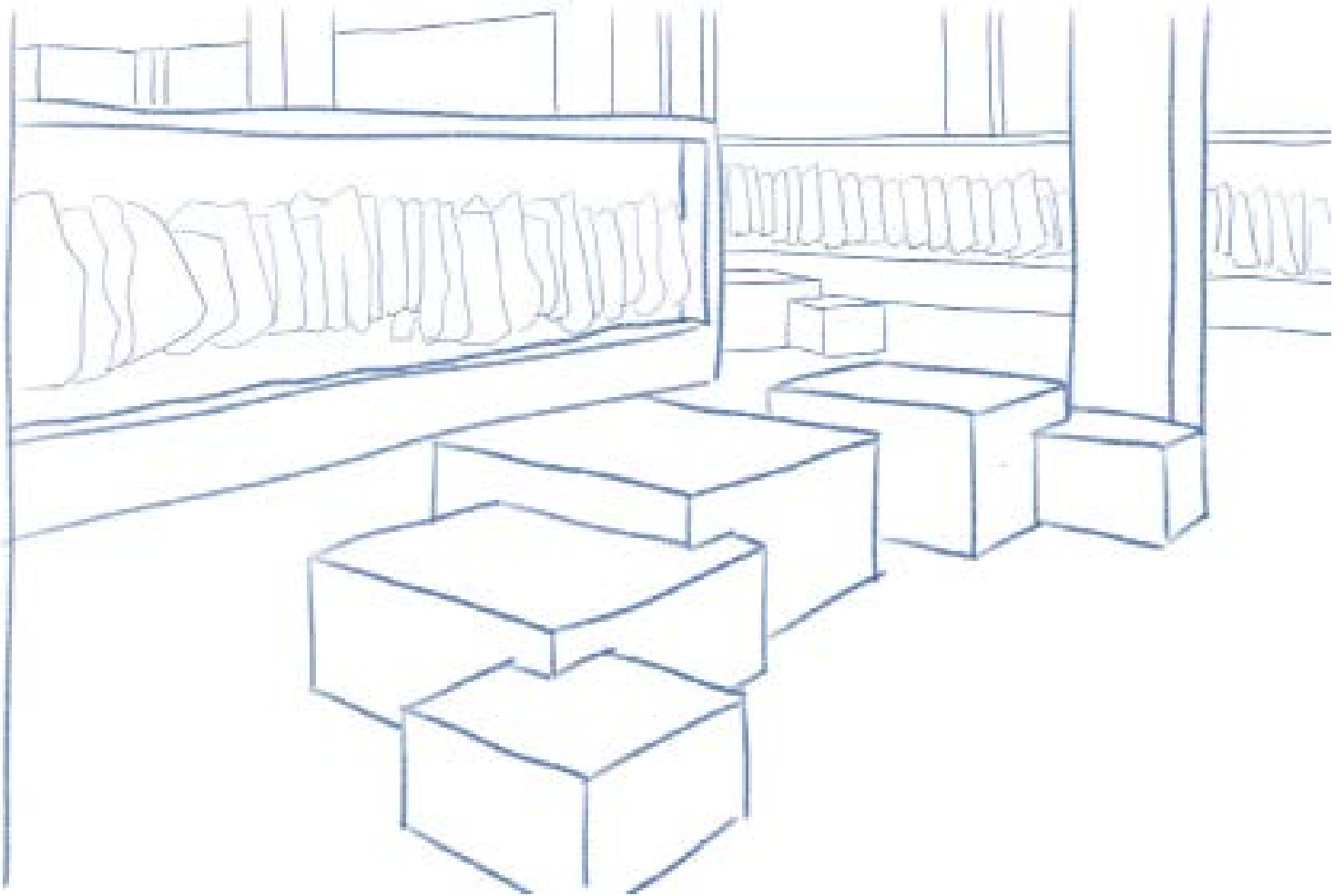

COMMERICAL DESIGN

FOR ELIE SAAB





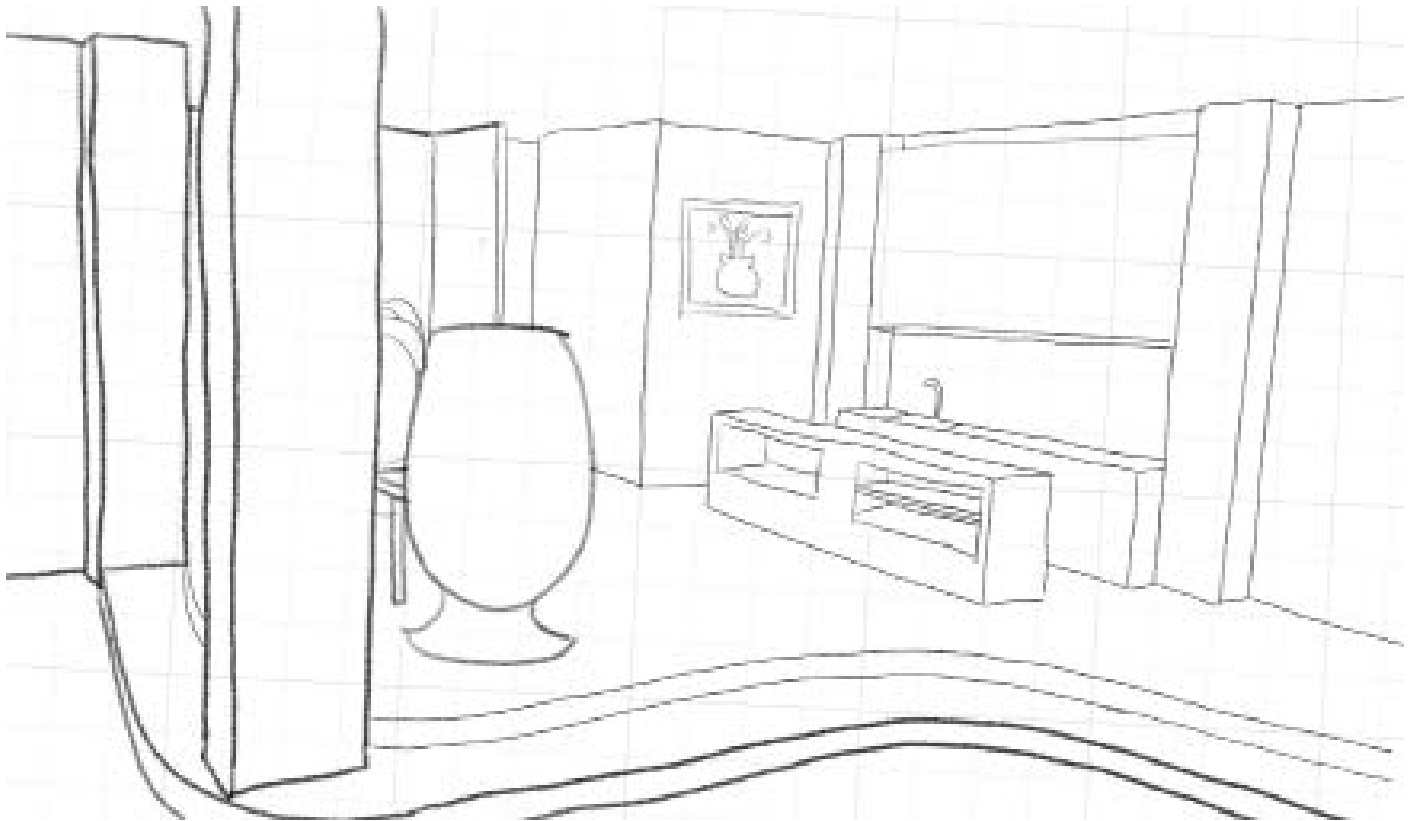

SKETCHES

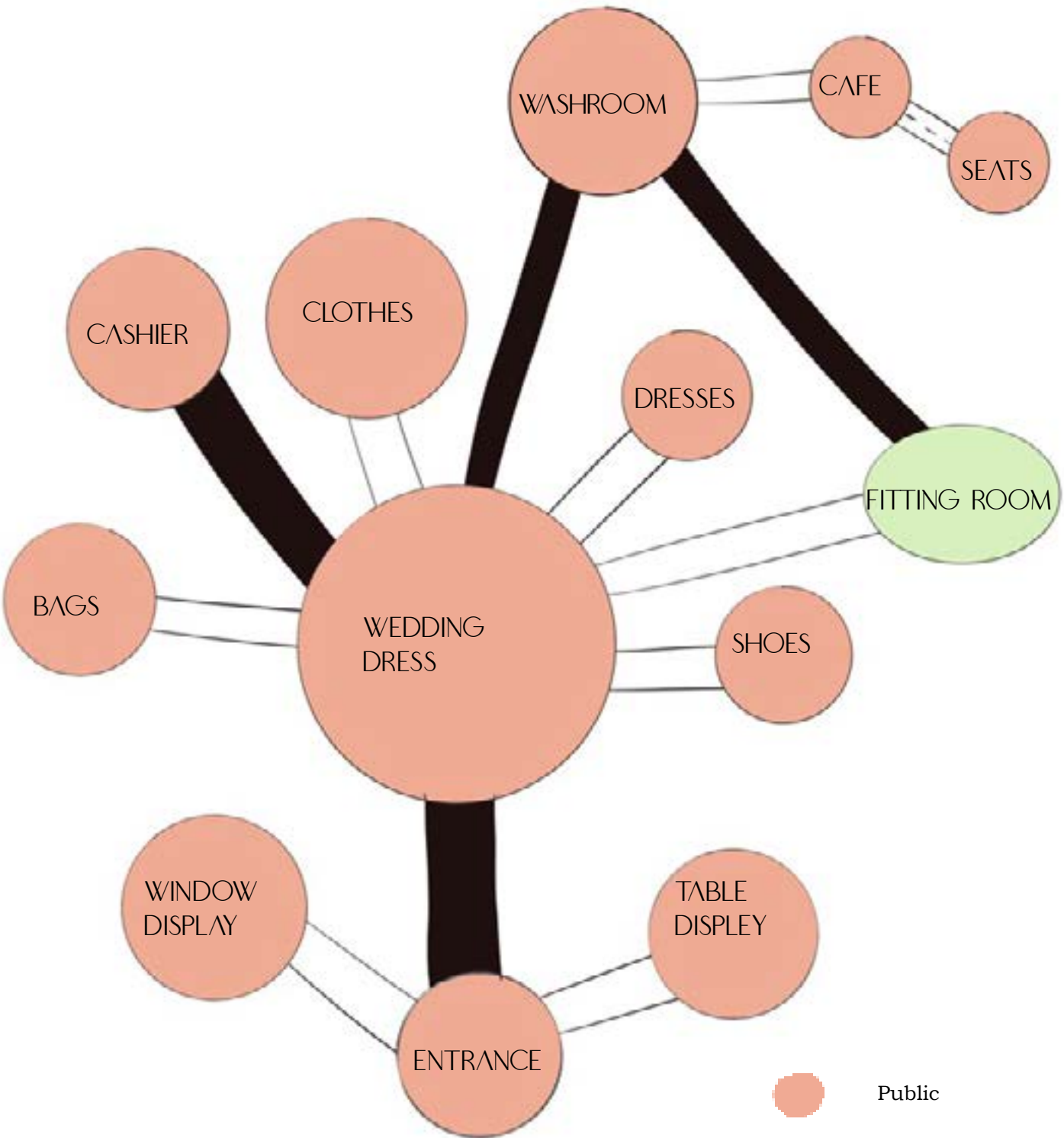
His design style is full of elegant and luxurious elements, which I would like to draw a contrast with his design through the simple environment.

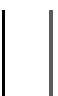

BUBBLE DIAGRAM



	Public		Major
	Working		Secondary
	Private		Tertiary
			View

CRITERIA MATRIX

	Quantity	People	Public for client	Privacy
DISPLAY	1- 12	8	HIGH	HIGH
CASHER	1	2	LOW	HIGH
CAFE	1	2	HIGH	LOW
WASHROOM	3	2	HIGH	HIGH
OFFICE	1	1	LOW	HIGH
STAFF ROOM	1	8	LOW	HIGH
STORGE	1	3	LOW	HIGH
GAG CHEACKING AREA	1	1	LOW	HIGH
RECEIVING AREA	1	3- 5	LOW	HIGH

ndary

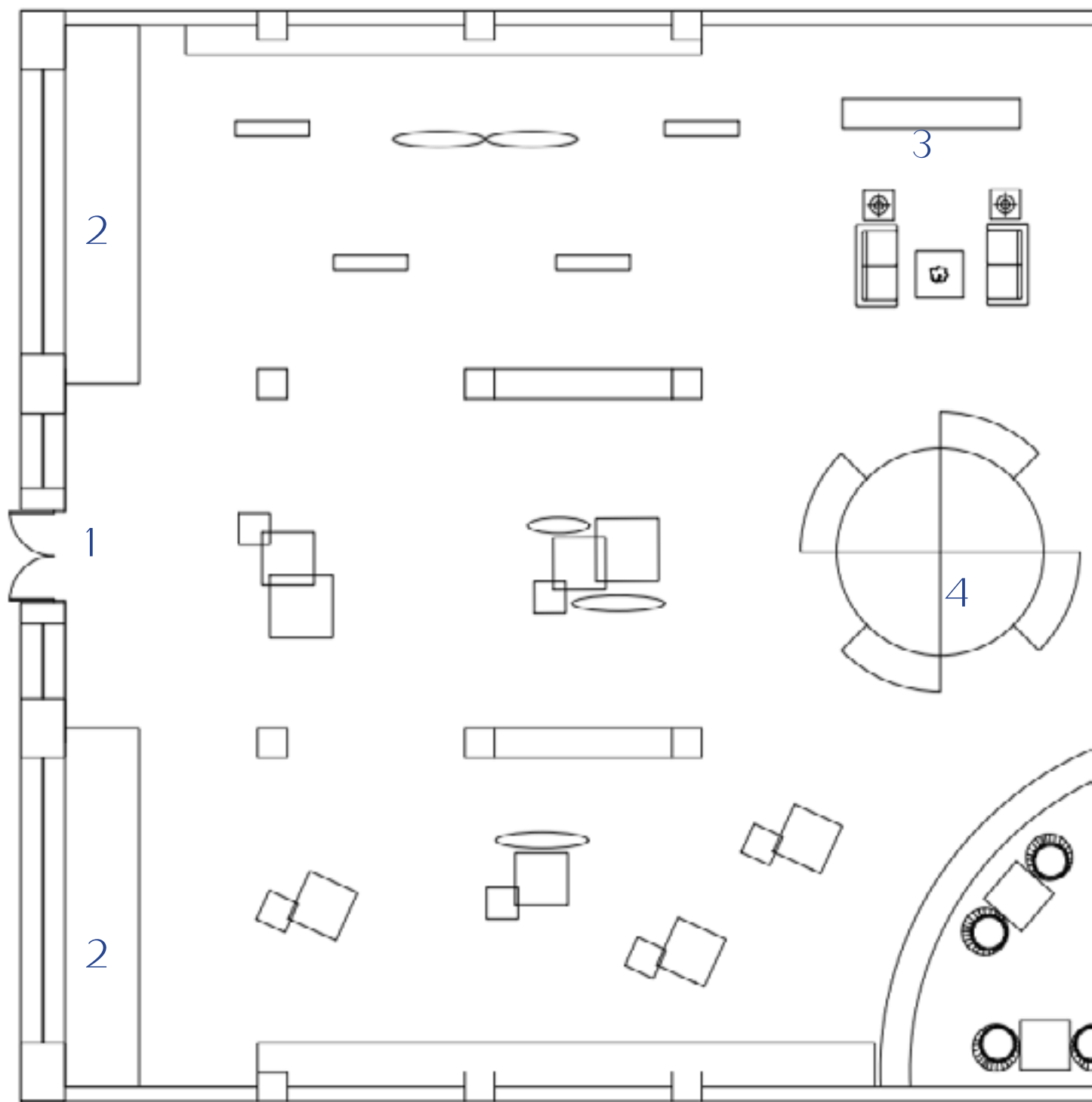

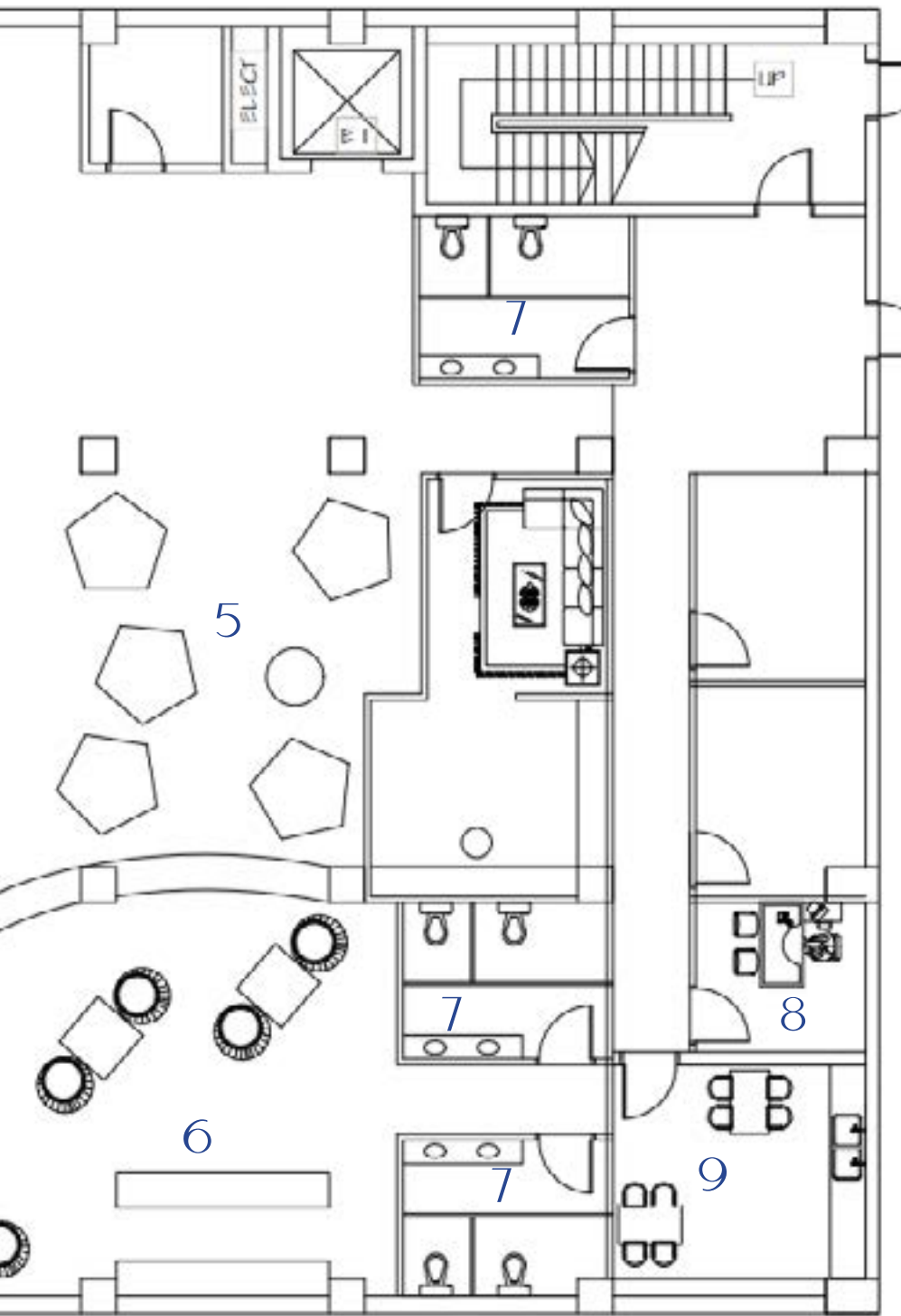

LEGEND:

- 1. Entrance
- 2. Window Display
- 3. Cashier
- 4. Wedding Dress
- 5. Fitting Room
- 6. Cafe
- 7. Washroom
- 8. Office
- 9. Staff Room

FLOOR PLAN

RENDERED FLOOR PLAN

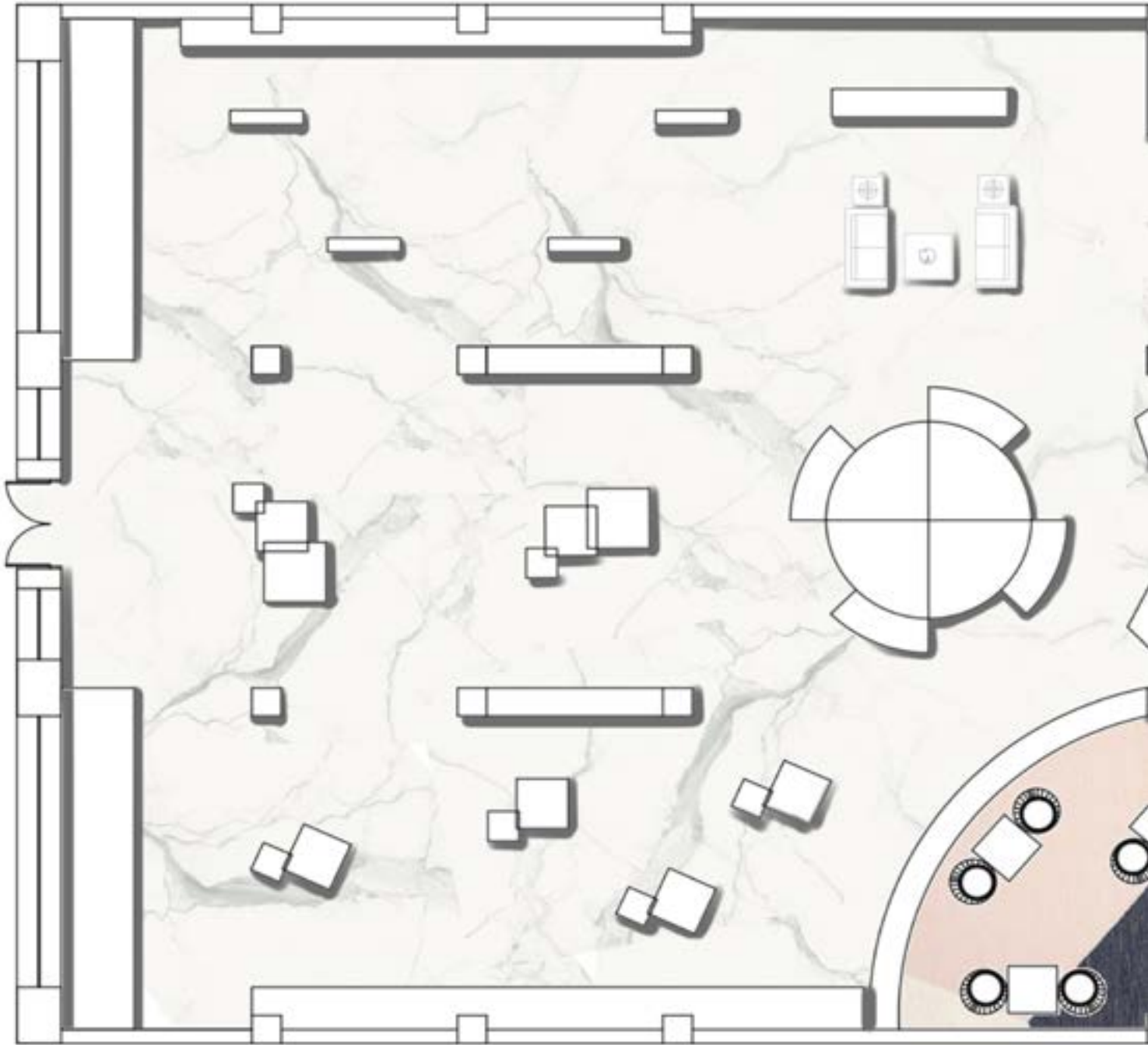

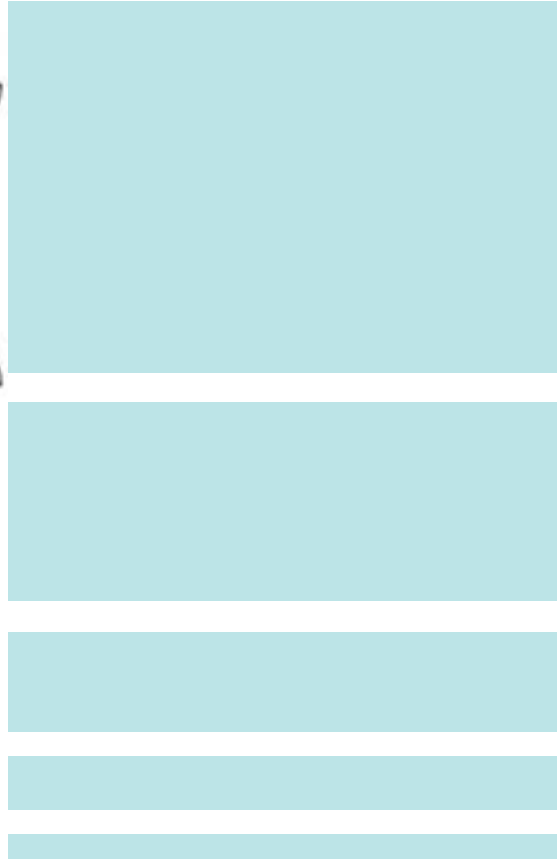

Elie Saab is a Lebanese fashion designer. He created a new high fashion clothes logo, which he used his name as a brand.

Elie Saab's dressing creates an atmosphere of elegance and refinement.

The first element in his design is elegance and luxury, which can be seen in almost all his works.

BIRD VIEW





ARCHITECTURAL VISUALIZATION

The store also has a small cafe inside of it, it is a soft and relax place for the customer.

Except the normal fitting room, it also provides a separate space for couples that want to try wedding dresses, which is really large for wearing dresses and make up.

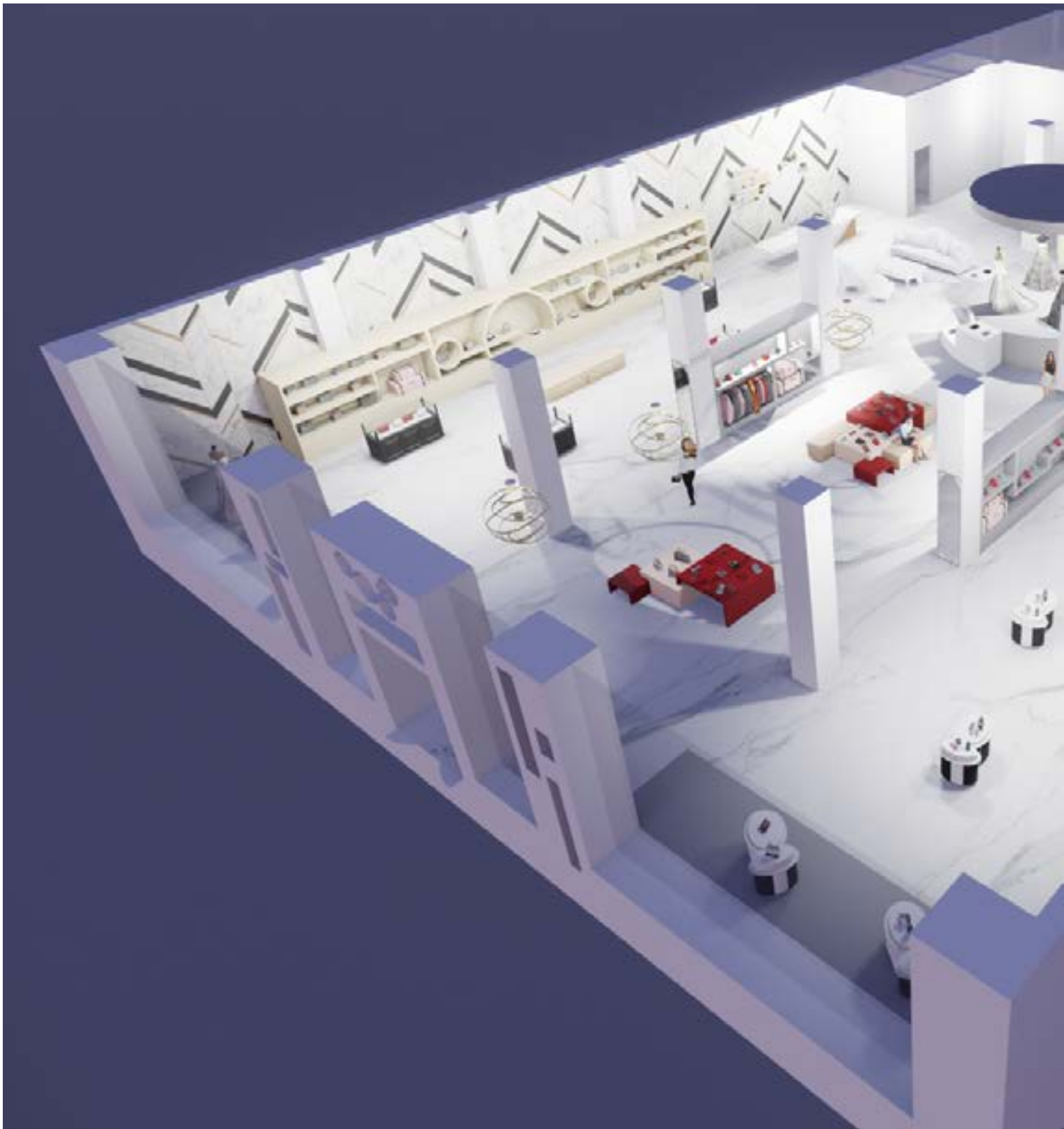

BIRD VIEW

ARCHITECTURAL VISUALIZATION



CAFE





RIGHT SIDE





ARCHITECTURAL VISUALIZATION

FRONT VIEW

CAFE





CENTER



ARCHITECTURAL VISUALIZATION



SECTION