

TATILA MANSUR  
INTERIOR DESIGN

# LIFTOFF & SKINN

WHITE ROCK - BC

The clinic is a fictional project created during senior project course, which has passed by all phases of the design conception process and included also the development of the brand.

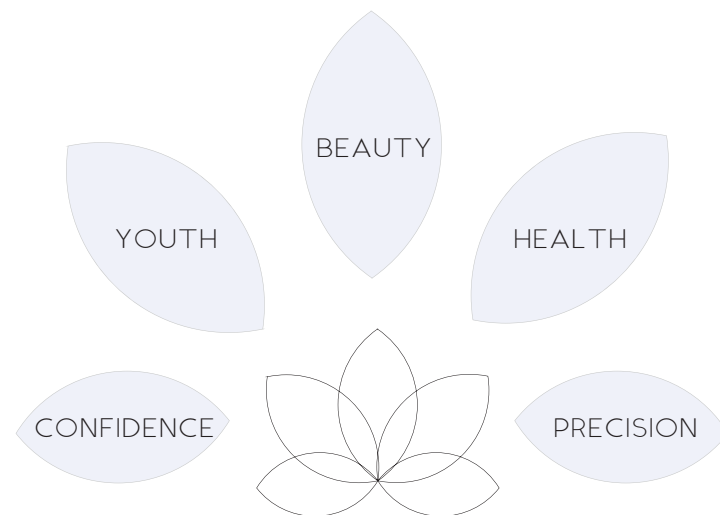

The choice for the lotus flower that represents divine beauty and purity, through delicate lines and elegance that this brand was developed, everything to gain the trust and space of the customer.



A clinical environmental partner with a retail component and makeup studio. For that, the layout naturally provides separation of medical and aesthetic areas, being divided in zones, all to ensure clients comfort and privacy, from the reception, procedure's rooms, to the recovery area

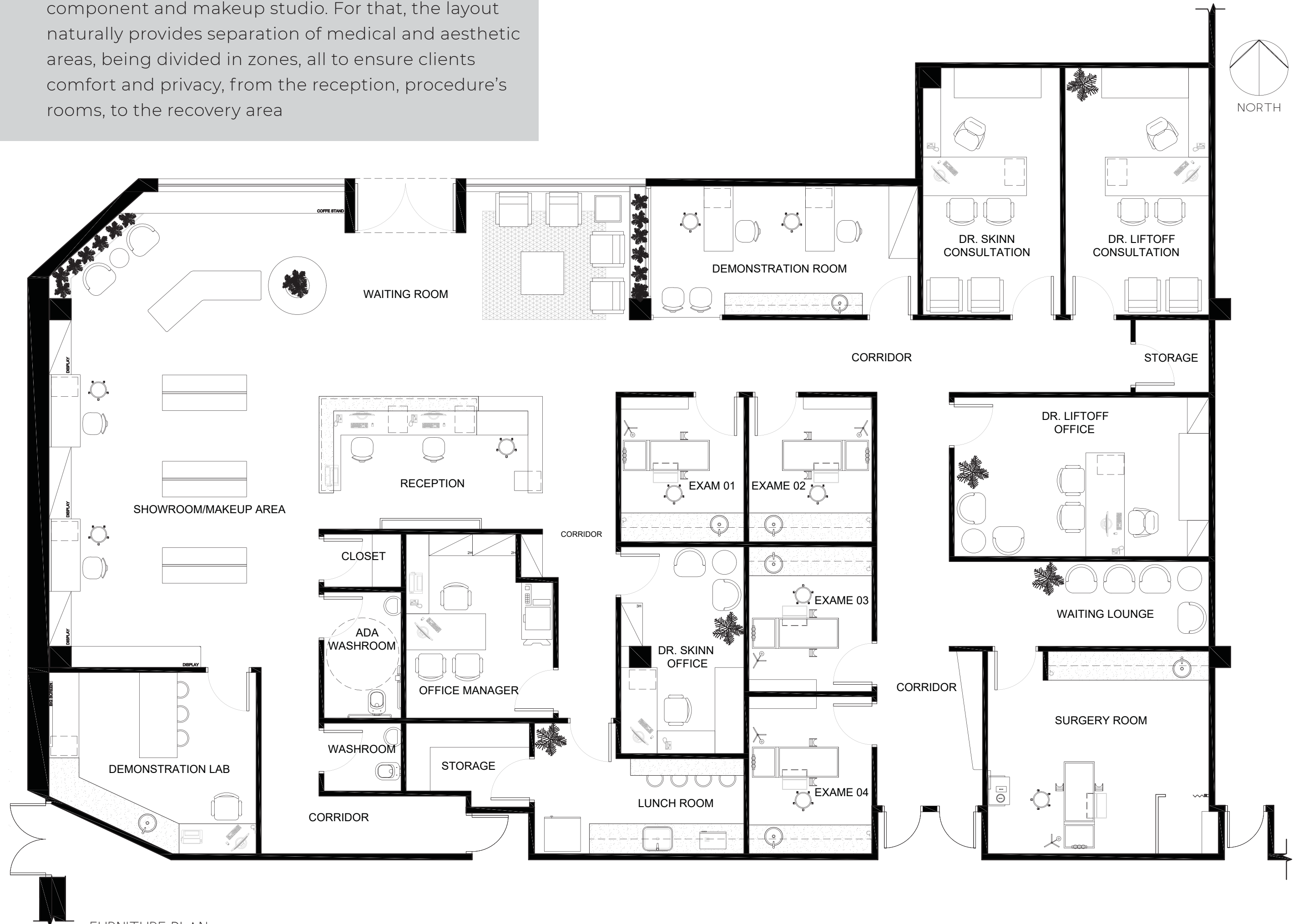

FURNITURE PLAN



## LIFTOFF & SKINN

WHITE ROCK - BC

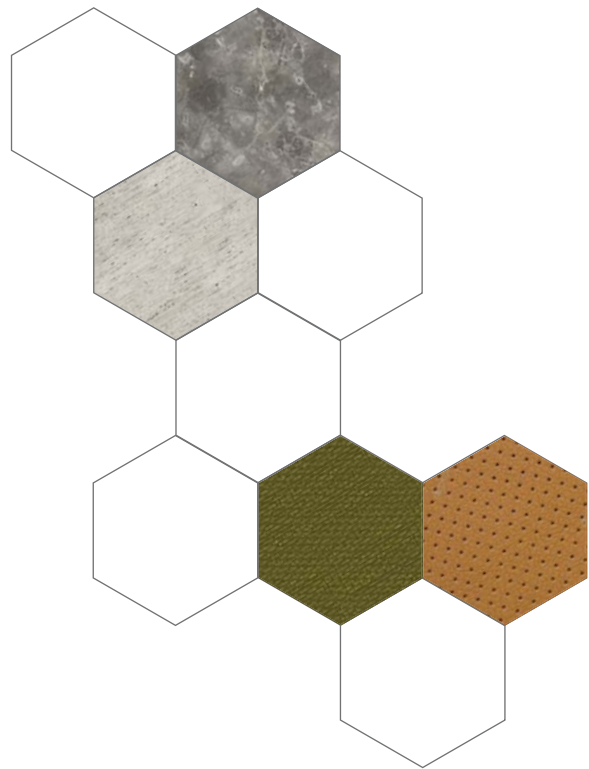

The LIFTOFF & SKINN clinic is a project that attaches aesthetic in two strands, the plastic surgery and makeup, also bringing small procedures and market products that will make the customer's life easy.







During the development of the project all the material options and finishes were chosen in order to make the enviromental invinting and comfortable





RETAIL - COSMETICS PRODUCTS



LIFTOFF & SKINN  
WHITE ROCK - BC





#### DEMONSTRATION LAB

An Educational zone, where customers will receive proper instructions for the use of products, as well as beauty workshops and courses